



1878 1878

1876 1876

1874 1874

1872 1872

1870 1870

1868 1868

1866 1866

1876 1876

1874 1874

1872 1872

1870 1870

1868 1868

1866 1866

1876 1876

1874 1874

1872 1872

1870 1870

1868 1868

1866 1866

Edge of Pavement - Left

T.O.C.

TAPER DITCH LINE TO MATCH EDGE OF PAVEMENT  
E.C.R. Myrtle St. STA. 0+53.00 20' Lt.  
E.C.R. EL. = 1873.87

TEMPORARY DITCH LINE

DAY ROAD STA. 21+02.42 23.5' RL = STA. 0+23.00 49.67' Lt.  
E.C.R. EL. 1874.14  
DITCH EL. 1872.14

E.C.P. Myrtle St. STA. 1+00.00 12' Lt.  
E.O.P. EL. 1873.35  
DITCH EL. 1871.35

End Sta. 4+95.0  
E.O.P. Elev. = 1870.89  
DITCH EL. = 1868.89

Centerline

0+00 = 23+51.89 Int. Spokane Road  
El. 1874.89

R.O.P. Sta. 0+22  
El. 1874.45

PVI Sta. 0+50  
El. 1873.89

Sta. 2+63.41 = Sta. 0+100 Tanager Lane  
Elev. = 1872.57

End Sta. 4+95.0  
Elev. = 1871.14

Finish Grade -0.618%  
Original Ground

Top of Curb - Right

-0.618%

E.C.R. Sta. 0+25.49 51.64' RL = STA. 24+04.11 23.5' RL  
E.C.R. EL. 1875.66

E.C.R. Sta. 0+55.46 20.0' RL  
E.C.R. EL. 1873.86

E.C.R. Sta. 2+20.06 20' RL  
E.C.R. EL. = 1872.84

E.C.R. Sta. 2+50.02 49.03' RL  
E.C.R. EL. = 1871.88

C1 Tanager Lane

E.C.R. Sta. 2+00.00 50.90' RL  
E.C.R. EL. = 1871.87

E.C.R. Sta. 3+18.07 20' RL  
E.C.R. EL. = 1872.28

End of Curb @ Sta. 4+95.0 20' RL  
Elev. = 1871.14

-0.618%

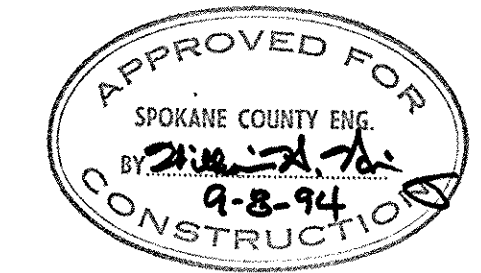

APPROVED FOR  
SPOKANE COUNTY ENG.  
BY: *[Signature]*  
9-8-94  
CONSTRUCTION

PERMIT REQUIRED!  
NOTIFY THE PERMIT ENGINEER  
456-3600  
24 HRS. PRIOR TO CONSTRUCTION

*Robert H. Pentecost*  
DEVELOPER APPROVAL  
DATE 9/1/94

PN-1711-93

TOTAL CONSULTANTS, INC.  
Architectural Engineering Environmental  
East 3102 Trent Avenue Spokane, Wa 99202  
(509) 536-4400 FAX: (509) 536-6086

Tanager East Profile - Myrtle Street	
Drawn By: SC, DB	Date: Aug 16, 1994
Sheet 4	of 7

# Road and Drainage Plans for Tanager East Subdivision PN 1711-93

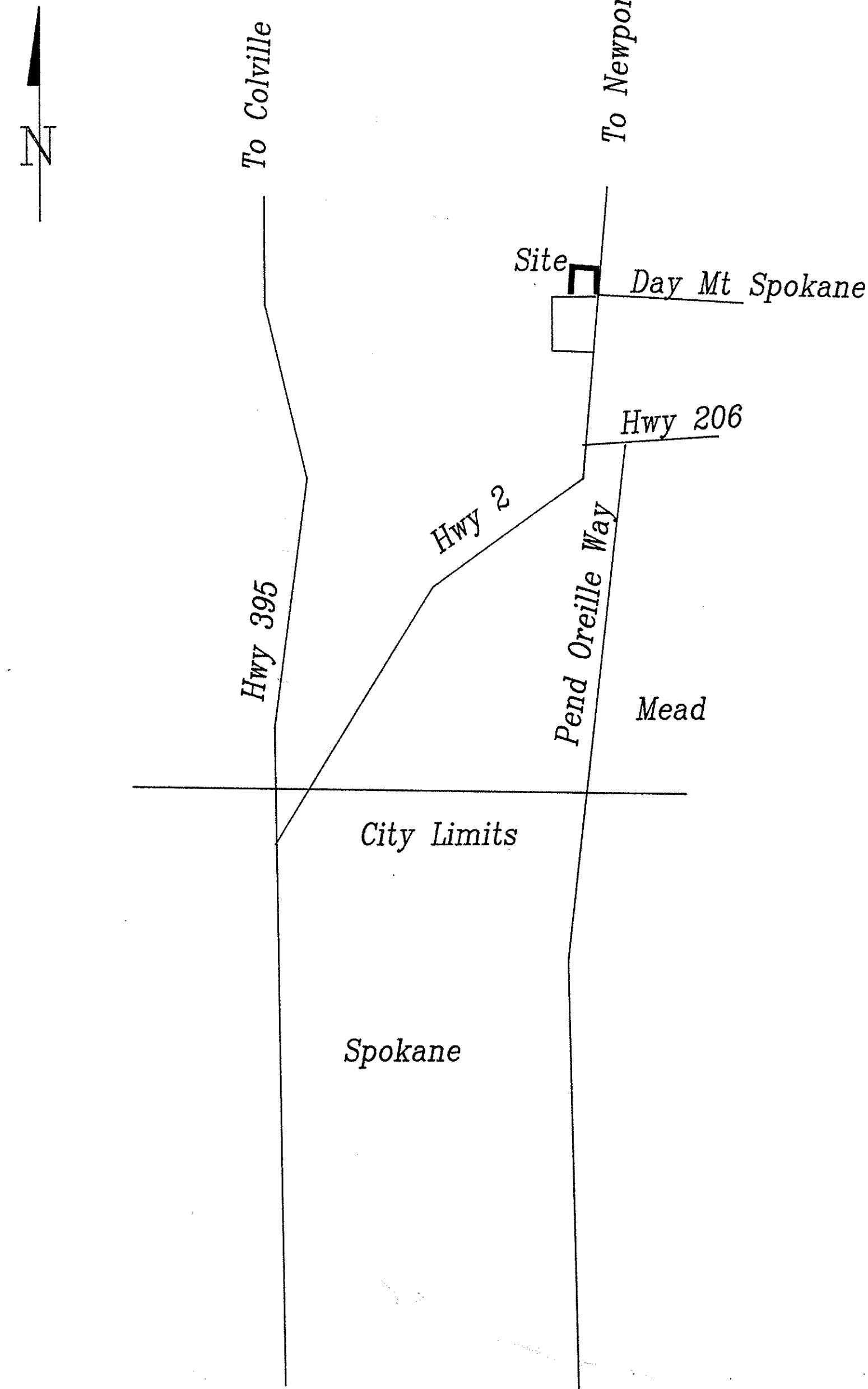

### List of Drawings

1. Title Sheet
2. Basin Map
3. Road Plan - Tanager Drive
4. Road Profile - Tanager Drive
5. Road Plan - Tanager Court
6. Road Profile - Tanager Court
7. Sight Distance Plan

Approved: \_\_\_\_\_  
 Chairman  
 Board of County Commissioners  
 Date: \_\_\_\_\_

Approved: \_\_\_\_\_  
 County Engineer  
 Date: \_\_\_\_\_

Approved: Robert H. Bartleson  
 Developer

Date: 9/1/94

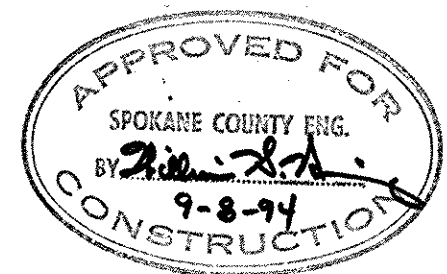
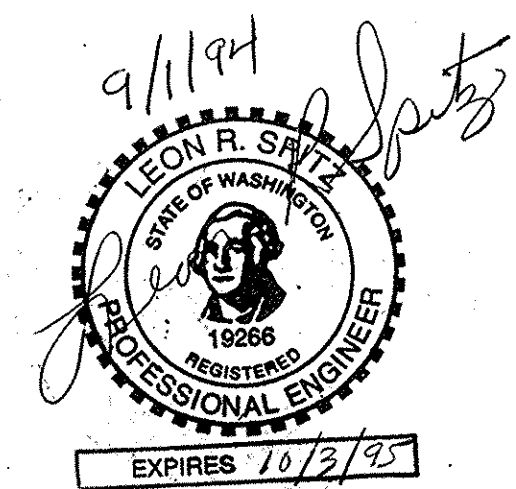

PERMIT REQUIRED!  
 NOTIFY THE PERMIT ENGINEER  
 456-3500  
 24 HRS. PRIOR TO CONSTRUCTION

TOTAL CONSULTANTS, INC.  
 Architectural Engineering Environmental  
 East 3102 Trent Avenue Spokane, Wa 99202  
 (509) 536-4400 FAX: (509) 536-6086

<b>Road Plans for Tanager East</b>		
Drawn By: <b>DMB</b>	Date: <b>Aug 18, 1994</b>	Sheet <b>1</b> of <b>7</b>





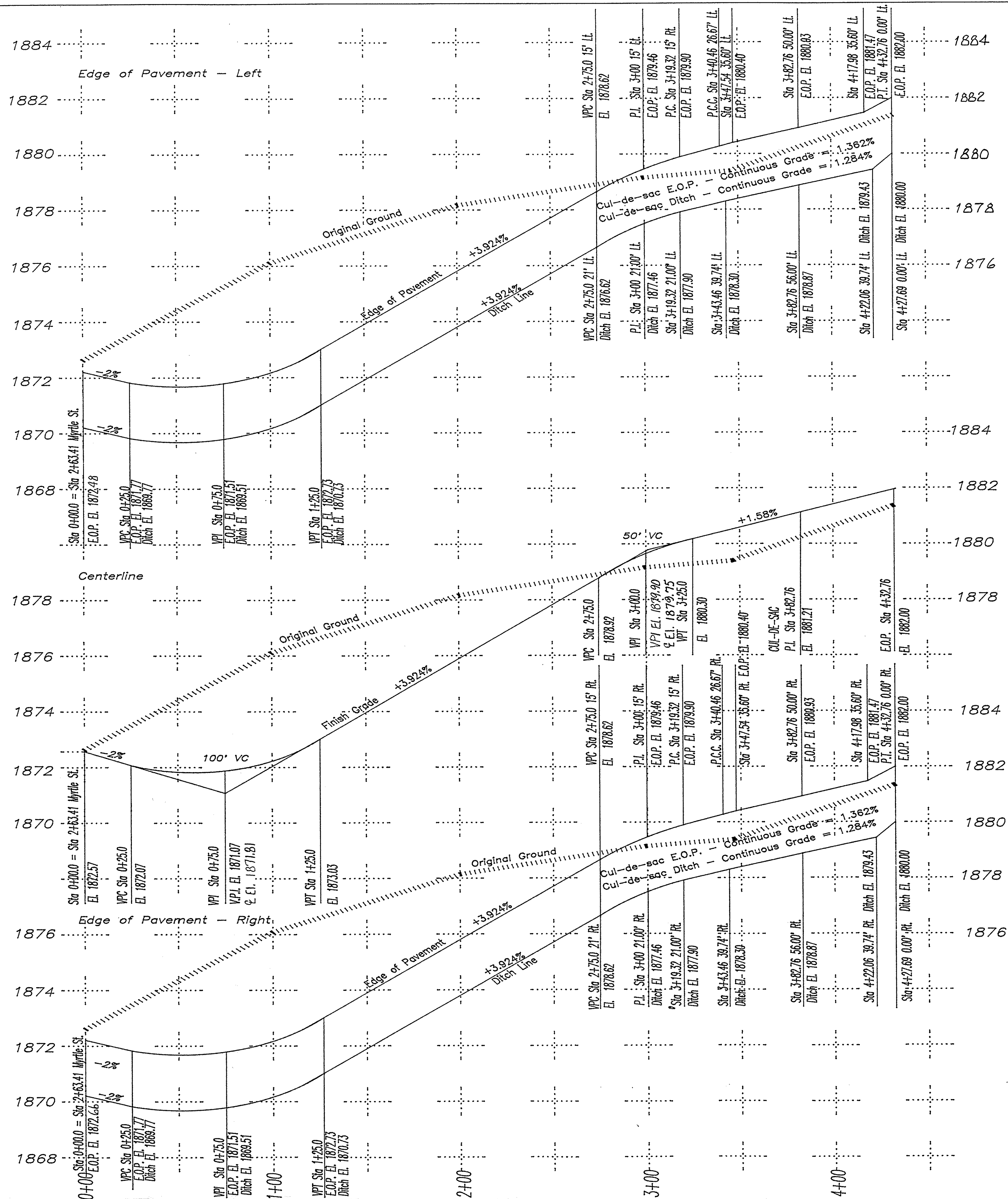

Note: EOP & ditch elevations, stations, & offsets vcorespond to spot elevations on Sheet 6  
 Note: Cul-De-Sac EOP & ditch grades calculated from arc lengths of the curves

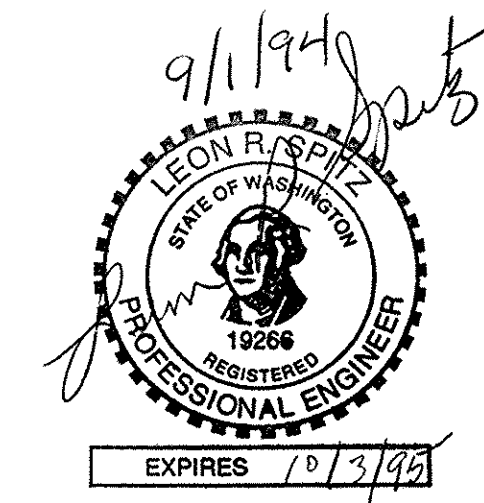

Robert H. Bartleson  
 9/1/94

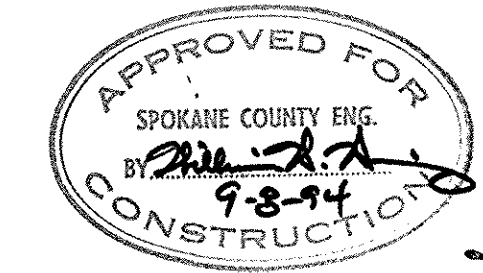

PERMIT REQUIRED!  
 NOTIFY THE PERMIT ENGINEER  
 456-3600  
 24 HRS. PRIOR TO CONSTRUCTION

TOTAL CONSULTANTS, INC.  
 Architectural Engineering Environmental  
 East 3102 Trent Avenue Spokane, Wa 99202  
 (509) 536-4400 FAX: (509) 536-6086

Tanager East PN-1711-93 Profile - Tanager Lane		
Drawn By: SC, DB	Date: Aug 16, 1994	Sheet 6 of 7

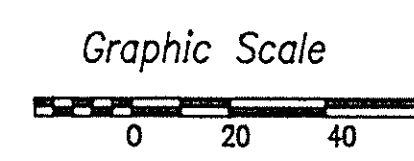
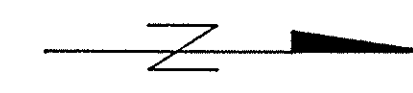

1 Inch = 40 Feet

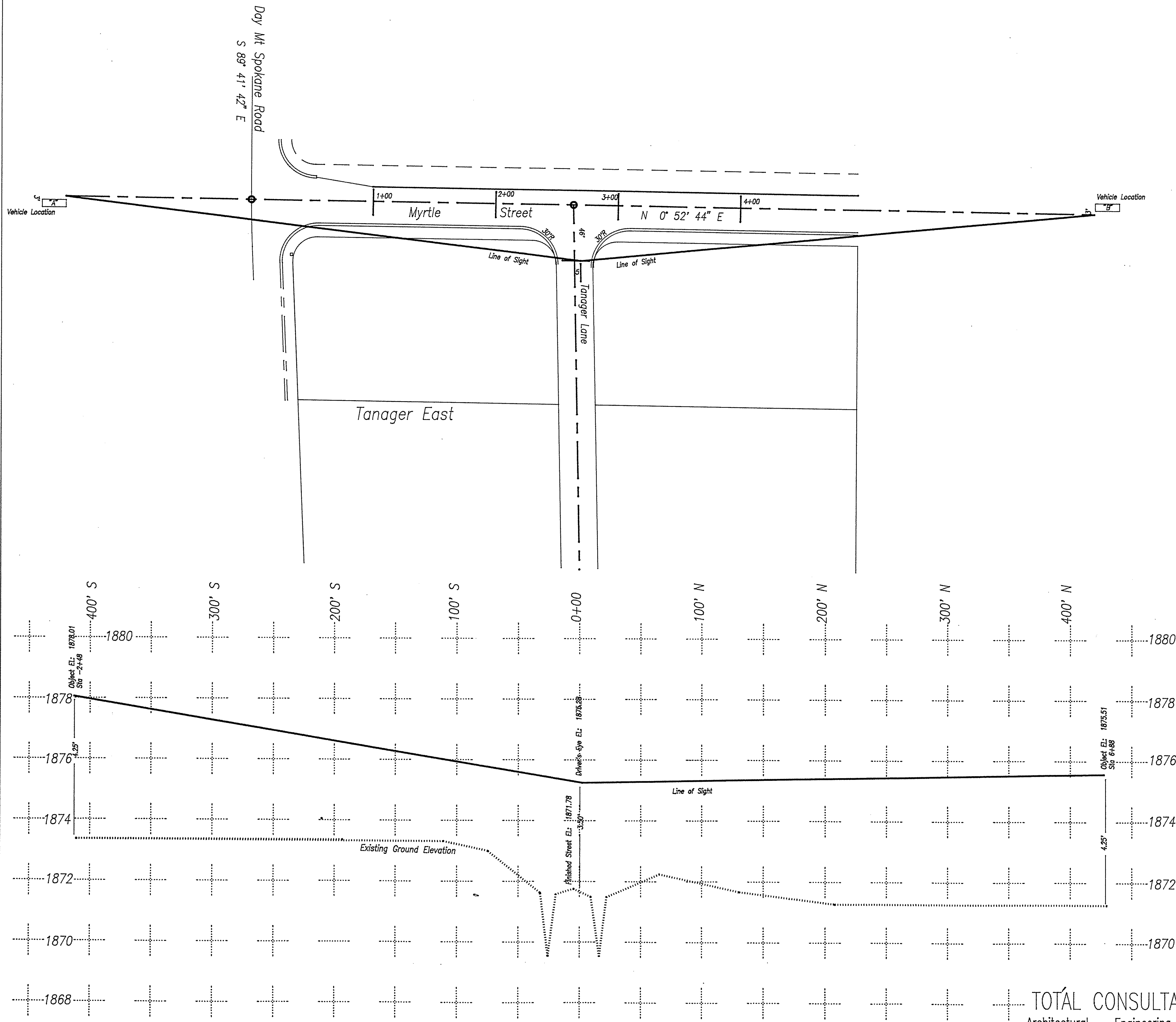

Robert A. [Name]  
9/1/94

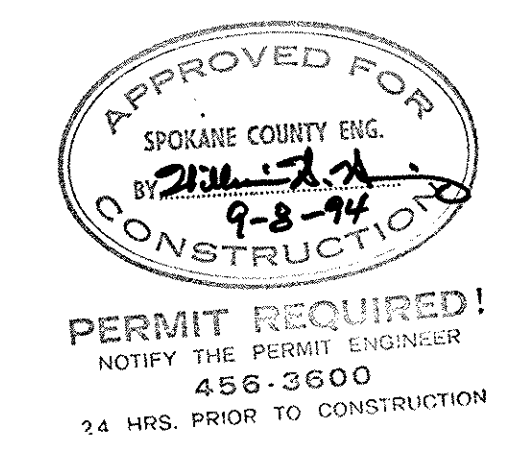

PN-1711-93

TOTAL CONSULTANTS, INC.  
Architcural Engineering Environmental  
East 3102 Trent Avenue Spokane, Wa 99202  
(509) 536-4400 FAX: (509) 536-6086

Tanager East Sight Distance Plan		
Drawn By: SC, DB	Date: Aug 18, 1994	Sheet 7 of 7