

GENERAL NOTES

1. THE DESIGNER'S RESPONSIBILITY IS LIMITED TO THE INFORMATION PROVIDED BY THE OWNER AND TO THE INFORMATION PROVIDED BY THE CONSULTING ENGINEER. THE DESIGNER SHALL NOT BE RESPONSIBLE FOR THE ACCURACY OF THE INFORMATION PROVIDED BY THE OWNER OR THE CONSULTING ENGINEER.

2. THE CONTRACTOR SHALL MAINTAIN ACCESS TO ALL EXISTING UTILITY LINES AND STRUCTURES. THE CONTRACTOR SHALL BE RESPONSIBLE FOR THE PROTECTION OF ALL EXISTING UTILITY LINES AND STRUCTURES.

3. THE CONTRACTOR SHALL BE RESPONSIBLE FOR THE PROTECTION OF ALL EXISTING UTILITY LINES AND STRUCTURES. THE CONTRACTOR SHALL BE RESPONSIBLE FOR THE PROTECTION OF ALL EXISTING UTILITY LINES AND STRUCTURES.

4. THE CONTRACTOR SHALL BE RESPONSIBLE FOR THE PROTECTION OF ALL EXISTING UTILITY LINES AND STRUCTURES. THE CONTRACTOR SHALL BE RESPONSIBLE FOR THE PROTECTION OF ALL EXISTING UTILITY LINES AND STRUCTURES.

5. THE CONTRACTOR SHALL BE RESPONSIBLE FOR THE PROTECTION OF ALL EXISTING UTILITY LINES AND STRUCTURES. THE CONTRACTOR SHALL BE RESPONSIBLE FOR THE PROTECTION OF ALL EXISTING UTILITY LINES AND STRUCTURES.

6. THE CONTRACTOR SHALL BE RESPONSIBLE FOR THE PROTECTION OF ALL EXISTING UTILITY LINES AND STRUCTURES. THE CONTRACTOR SHALL BE RESPONSIBLE FOR THE PROTECTION OF ALL EXISTING UTILITY LINES AND STRUCTURES.

7. THE CONTRACTOR SHALL BE RESPONSIBLE FOR THE PROTECTION OF ALL EXISTING UTILITY LINES AND STRUCTURES. THE CONTRACTOR SHALL BE RESPONSIBLE FOR THE PROTECTION OF ALL EXISTING UTILITY LINES AND STRUCTURES.

8. THE CONTRACTOR SHALL BE RESPONSIBLE FOR THE PROTECTION OF ALL EXISTING UTILITY LINES AND STRUCTURES. THE CONTRACTOR SHALL BE RESPONSIBLE FOR THE PROTECTION OF ALL EXISTING UTILITY LINES AND STRUCTURES.

9. THE CONTRACTOR SHALL BE RESPONSIBLE FOR THE PROTECTION OF ALL EXISTING UTILITY LINES AND STRUCTURES. THE CONTRACTOR SHALL BE RESPONSIBLE FOR THE PROTECTION OF ALL EXISTING UTILITY LINES AND STRUCTURES.

10. THE CONTRACTOR SHALL BE RESPONSIBLE FOR THE PROTECTION OF ALL EXISTING UTILITY LINES AND STRUCTURES. THE CONTRACTOR SHALL BE RESPONSIBLE FOR THE PROTECTION OF ALL EXISTING UTILITY LINES AND STRUCTURES.

11. THE CONTRACTOR SHALL BE RESPONSIBLE FOR THE PROTECTION OF ALL EXISTING UTILITY LINES AND STRUCTURES. THE CONTRACTOR SHALL BE RESPONSIBLE FOR THE PROTECTION OF ALL EXISTING UTILITY LINES AND STRUCTURES.

12. THE CONTRACTOR SHALL BE RESPONSIBLE FOR THE PROTECTION OF ALL EXISTING UTILITY LINES AND STRUCTURES. THE CONTRACTOR SHALL BE RESPONSIBLE FOR THE PROTECTION OF ALL EXISTING UTILITY LINES AND STRUCTURES.

13. THE CONTRACTOR SHALL BE RESPONSIBLE FOR THE PROTECTION OF ALL EXISTING UTILITY LINES AND STRUCTURES. THE CONTRACTOR SHALL BE RESPONSIBLE FOR THE PROTECTION OF ALL EXISTING UTILITY LINES AND STRUCTURES.

14. THE CONTRACTOR SHALL BE RESPONSIBLE FOR THE PROTECTION OF ALL EXISTING UTILITY LINES AND STRUCTURES. THE CONTRACTOR SHALL BE RESPONSIBLE FOR THE PROTECTION OF ALL EXISTING UTILITY LINES AND STRUCTURES.

15. THE CONTRACTOR SHALL BE RESPONSIBLE FOR THE PROTECTION OF ALL EXISTING UTILITY LINES AND STRUCTURES. THE CONTRACTOR SHALL BE RESPONSIBLE FOR THE PROTECTION OF ALL EXISTING UTILITY LINES AND STRUCTURES.

16. THE CONTRACTOR SHALL BE RESPONSIBLE FOR THE PROTECTION OF ALL EXISTING UTILITY LINES AND STRUCTURES. THE CONTRACTOR SHALL BE RESPONSIBLE FOR THE PROTECTION OF ALL EXISTING UTILITY LINES AND STRUCTURES.

17. THE CONTRACTOR SHALL BE RESPONSIBLE FOR THE PROTECTION OF ALL EXISTING UTILITY LINES AND STRUCTURES. THE CONTRACTOR SHALL BE RESPONSIBLE FOR THE PROTECTION OF ALL EXISTING UTILITY LINES AND STRUCTURES.

18. THE CONTRACTOR SHALL BE RESPONSIBLE FOR THE PROTECTION OF ALL EXISTING UTILITY LINES AND STRUCTURES. THE CONTRACTOR SHALL BE RESPONSIBLE FOR THE PROTECTION OF ALL EXISTING UTILITY LINES AND STRUCTURES.

19. THE CONTRACTOR SHALL BE RESPONSIBLE FOR THE PROTECTION OF ALL EXISTING UTILITY LINES AND STRUCTURES. THE CONTRACTOR SHALL BE RESPONSIBLE FOR THE PROTECTION OF ALL EXISTING UTILITY LINES AND STRUCTURES.

TAKODA PARK PHASE II STREET AND DRAINAGE PLANS SPOKANE COUNTY, WASHINGTON NW 1/4 SECTION 8, T. 24 N., R. 42 E., W.M.

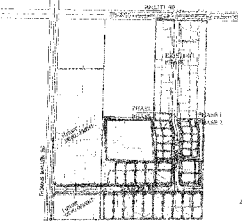
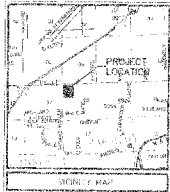

SITE PLAN

INDEX TO PLAN SHEETS

- SHEET 1 COVER SHEET
SHEET 2 DILLMAN ROAD PLAN & PROFILE
SHEET 3 WINNIE ROAD PLAN & PROFILE
SHEET 4 THOMAS MALLEN ROAD PLAN & PROFILE
SHEET 5 HYDRA SECTION DETAILS
SHEET 6 OVERALL DRAINAGE PLAN
SHEET 7 STORM DRAINAGE PLAN & PROFILE
SHEET 8 STORM DRAINAGE PLAN & PROFILE
SHEET 9 POND DETAIL
SHEET 10 POND DETAILS
SHEET 11 CROSS-SECTION COVER SHEET
SHEET 12 DIVISION CONTROL PLAN & DETAIL

ABBREVIATIONS

Table listing various symbols and abbreviations used in the plans, such as 'S-1' for storm sewer, 'D-1' for drainage ditch, etc.

SCALE

Table providing scales for different parts of the plan, including horizontal and vertical scales.



Legend table defining symbols for various features like 'DRAINAGE DITCH', 'STORM SEWER', 'POND DETAIL', etc.



STREET AND DRAINAGE PLANS TAKODA PARK PHASE II

SHEET 2 OF 12

SPOKANE COUNTY, WASHINGTON



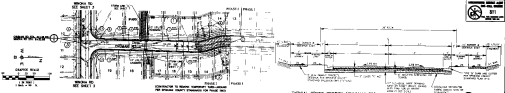

STATION	CHORD BEARING	CHORD LENGTH	CHORD CURVATURE	CHORD AREA
1+00	105° 00' 00"	100.00	0.0000	0.0000
1+20	105° 00' 00"	100.00	0.0000	0.0000
1+40	105° 00' 00"	100.00	0.0000	0.0000
1+60	105° 00' 00"	100.00	0.0000	0.0000
1+80	105° 00' 00"	100.00	0.0000	0.0000
2+00	105° 00' 00"	100.00	0.0000	0.0000
2+20	105° 00' 00"	100.00	0.0000	0.0000
2+40	105° 00' 00"	100.00	0.0000	0.0000
2+60	105° 00' 00"	100.00	0.0000	0.0000
2+80	105° 00' 00"	100.00	0.0000	0.0000
3+00	105° 00' 00"	100.00	0.0000	0.0000

- ### CONSTRUCTION NOTES
- 1. SEE PLAN FOR ALL DIMENSIONS AND LOCATIONS.
  - 2. ALL WORK SHALL BE DONE IN ACCORDANCE WITH THE STANDARD SPECIFICATIONS FOR HIGHWAY CONSTRUCTION, 2003 EDITION, WITH THE LATEST REVISIONS.
  - 3. THE CONTRACTOR SHALL BE RESPONSIBLE FOR OBTAINING ALL NECESSARY PERMITS AND APPROVALS FROM THE APPROPRIATE AGENCIES.
  - 4. THE CONTRACTOR SHALL MAINTAIN ACCESS TO ALL ADJACENT PROPERTIES AT ALL TIMES.
  - 5. THE CONTRACTOR SHALL BE RESPONSIBLE FOR THE PROTECTION OF ALL UTILITIES AND STRUCTURES TO REMAIN.
  - 6. THE CONTRACTOR SHALL MAINTAIN ADEQUATE DRAINAGE THROUGHOUT THE PROJECT.
  - 7. THE CONTRACTOR SHALL MAINTAIN ADEQUATE EROSION CONTROL MEASURES THROUGHOUT THE PROJECT.
  - 8. THE CONTRACTOR SHALL MAINTAIN ADEQUATE TRAFFIC CONTROL THROUGHOUT THE PROJECT.
  - 9. THE CONTRACTOR SHALL MAINTAIN ADEQUATE SAFETY MEASURES THROUGHOUT THE PROJECT.
  - 10. THE CONTRACTOR SHALL MAINTAIN ADEQUATE RECORD DRAWINGS THROUGHOUT THE PROJECT.

TYPICAL CROSS SECTION (DRAINAGE 200)

SEE PLAN FOR CURVE AND OFFSET TO THE END OF CURVE

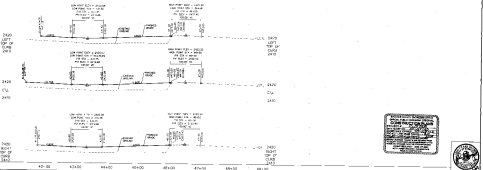

PROVIDE ALL NECESSARY PERMITS AND APPROVALS FROM THE APPROPRIATE AGENCIES.

NO.	DESCRIPTION	DATE
1	REVISION	12/31/2024
2	REVISION	12/31/2024
3	REVISION	12/31/2024
4	REVISION	12/31/2024
5	REVISION	12/31/2024

SCALE: HORIZONTAL: 1" = 40' VERTICAL: 1" = 10'



STREET AND DRAINAGE PLAN  
YAKODA PARK PHASE II  
CHANDLER ROAD STA 41+00 TO STA 68+00  
SPokane County, Washington

PROJECT  
S-11-14  
JOB NO. 2008-138

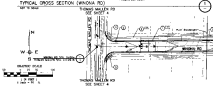
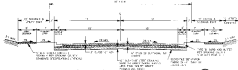

WINDOW WELLS  
 1:36 = 1" = 6'

CONCRETE		STEEL	
CLASS	TYPE	GRADE	THICKNESS
C1	CONCRETE	500	4"
C2	CONCRETE	4000	4"
C3	CONCRETE	4000	4"
C4	CONCRETE	4000	4"
C5	CONCRETE	4000	4"

NOTE: SEE SPEC FOR CURB & GUTTER & TOP FINISH OF CURB.

- CONSTRUCTION NOTES**
- CONCRETE SHALL BE PLACED AND CURED PER STANDARD PRACTICE (SECTION 2.02)
  - CONCRETE SHALL BE PLACED AND CURED PER STANDARD PRACTICE (SECTION 2.02)
  - CONCRETE SHALL BE PLACED AND CURED PER STANDARD PRACTICE (SECTION 2.02)
  - CONCRETE SHALL BE PLACED AND CURED PER STANDARD PRACTICE (SECTION 2.02)
  - CONCRETE SHALL BE PLACED AND CURED PER STANDARD PRACTICE (SECTION 2.02)
  - CONCRETE SHALL BE PLACED AND CURED PER STANDARD PRACTICE (SECTION 2.02)
  - CONCRETE SHALL BE PLACED AND CURED PER STANDARD PRACTICE (SECTION 2.02)
  - CONCRETE SHALL BE PLACED AND CURED PER STANDARD PRACTICE (SECTION 2.02)
  - CONCRETE SHALL BE PLACED AND CURED PER STANDARD PRACTICE (SECTION 2.02)
  - CONCRETE SHALL BE PLACED AND CURED PER STANDARD PRACTICE (SECTION 2.02)
  - CONCRETE SHALL BE PLACED AND CURED PER STANDARD PRACTICE (SECTION 2.02)
  - CONCRETE SHALL BE PLACED AND CURED PER STANDARD PRACTICE (SECTION 2.02)
  - CONCRETE SHALL BE PLACED AND CURED PER STANDARD PRACTICE (SECTION 2.02)
  - CONCRETE SHALL BE PLACED AND CURED PER STANDARD PRACTICE (SECTION 2.02)
  - CONCRETE SHALL BE PLACED AND CURED PER STANDARD PRACTICE (SECTION 2.02)
  - CONCRETE SHALL BE PLACED AND CURED PER STANDARD PRACTICE (SECTION 2.02)
  - CONCRETE SHALL BE PLACED AND CURED PER STANDARD PRACTICE (SECTION 2.02)
  - CONCRETE SHALL BE PLACED AND CURED PER STANDARD PRACTICE (SECTION 2.02)
  - CONCRETE SHALL BE PLACED AND CURED PER STANDARD PRACTICE (SECTION 2.02)
  - CONCRETE SHALL BE PLACED AND CURED PER STANDARD PRACTICE (SECTION 2.02)

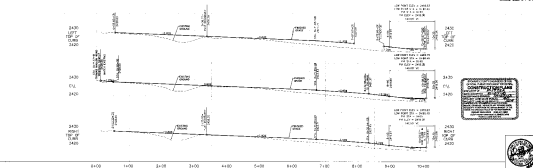

**CONSTRUCTION NOTES**

- CONCRETE SHALL BE PLACED AND CURED PER STANDARD PRACTICE (SECTION 2.02)
- CONCRETE SHALL BE PLACED AND CURED PER STANDARD PRACTICE (SECTION 2.02)
- CONCRETE SHALL BE PLACED AND CURED PER STANDARD PRACTICE (SECTION 2.02)
- CONCRETE SHALL BE PLACED AND CURED PER STANDARD PRACTICE (SECTION 2.02)
- CONCRETE SHALL BE PLACED AND CURED PER STANDARD PRACTICE (SECTION 2.02)
- CONCRETE SHALL BE PLACED AND CURED PER STANDARD PRACTICE (SECTION 2.02)
- CONCRETE SHALL BE PLACED AND CURED PER STANDARD PRACTICE (SECTION 2.02)
- CONCRETE SHALL BE PLACED AND CURED PER STANDARD PRACTICE (SECTION 2.02)
- CONCRETE SHALL BE PLACED AND CURED PER STANDARD PRACTICE (SECTION 2.02)
- CONCRETE SHALL BE PLACED AND CURED PER STANDARD PRACTICE (SECTION 2.02)
- CONCRETE SHALL BE PLACED AND CURED PER STANDARD PRACTICE (SECTION 2.02)
- CONCRETE SHALL BE PLACED AND CURED PER STANDARD PRACTICE (SECTION 2.02)
- CONCRETE SHALL BE PLACED AND CURED PER STANDARD PRACTICE (SECTION 2.02)
- CONCRETE SHALL BE PLACED AND CURED PER STANDARD PRACTICE (SECTION 2.02)
- CONCRETE SHALL BE PLACED AND CURED PER STANDARD PRACTICE (SECTION 2.02)
- CONCRETE SHALL BE PLACED AND CURED PER STANDARD PRACTICE (SECTION 2.02)
- CONCRETE SHALL BE PLACED AND CURED PER STANDARD PRACTICE (SECTION 2.02)
- CONCRETE SHALL BE PLACED AND CURED PER STANDARD PRACTICE (SECTION 2.02)
- CONCRETE SHALL BE PLACED AND CURED PER STANDARD PRACTICE (SECTION 2.02)
- CONCRETE SHALL BE PLACED AND CURED PER STANDARD PRACTICE (SECTION 2.02)

<b>SCALE</b>				<b>SCALE</b>				<b>IWCE</b>	<b>STREET AND DRAINAGE PLANS TAKODA PARK PHASE II</b>	<b>SHEET 2 OF 12</b>
HORIZONTAL				VERTICAL						
AS SHOWN				AS SHOWN						
IN FEET				IN FEET						
AS SHOWN				AS SHOWN				<b>DESIGNED BY</b>		<b>DATE</b>
AS SHOWN				AS SHOWN				10/18/09		
AS SHOWN				AS SHOWN				10/18/09		
AS SHOWN				AS SHOWN				10/18/09		

SECTION 4.02, W-1  
 WYKANE COUNTY, WASHINGTON

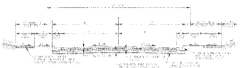

EMERGENCY GRAVEL ACCESS  
 10' WIDE

NO.	DATE	DESCRIPTION
1	10/1/14	ISSUED FOR PERMITS
2	10/1/14	ISSUED FOR PERMITS
3	10/1/14	ISSUED FOR PERMITS
4	10/1/14	ISSUED FOR PERMITS
5	10/1/14	ISSUED FOR PERMITS
6	10/1/14	ISSUED FOR PERMITS
7	10/1/14	ISSUED FOR PERMITS
8	10/1/14	ISSUED FOR PERMITS
9	10/1/14	ISSUED FOR PERMITS
10	10/1/14	ISSUED FOR PERMITS

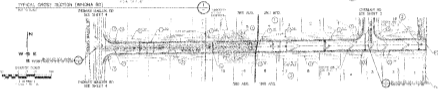

- CONSTRUCTION NOTES**
1. VERIFY ALL DIMENSIONS AND LOCATIONS WITH THE FIELD ENGINEER BEFORE CONSTRUCTION.
  2. VERIFY ALL DIMENSIONS AND LOCATIONS WITH THE FIELD ENGINEER BEFORE CONSTRUCTION.
  3. VERIFY ALL DIMENSIONS AND LOCATIONS WITH THE FIELD ENGINEER BEFORE CONSTRUCTION.
  4. VERIFY ALL DIMENSIONS AND LOCATIONS WITH THE FIELD ENGINEER BEFORE CONSTRUCTION.
  5. VERIFY ALL DIMENSIONS AND LOCATIONS WITH THE FIELD ENGINEER BEFORE CONSTRUCTION.
  6. VERIFY ALL DIMENSIONS AND LOCATIONS WITH THE FIELD ENGINEER BEFORE CONSTRUCTION.
  7. VERIFY ALL DIMENSIONS AND LOCATIONS WITH THE FIELD ENGINEER BEFORE CONSTRUCTION.
  8. VERIFY ALL DIMENSIONS AND LOCATIONS WITH THE FIELD ENGINEER BEFORE CONSTRUCTION.
  9. VERIFY ALL DIMENSIONS AND LOCATIONS WITH THE FIELD ENGINEER BEFORE CONSTRUCTION.
  10. VERIFY ALL DIMENSIONS AND LOCATIONS WITH THE FIELD ENGINEER BEFORE CONSTRUCTION.

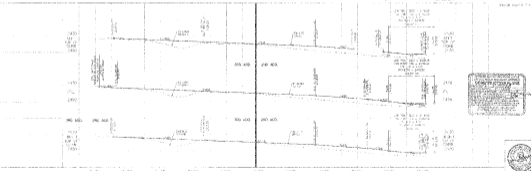

<p><b>REVISIONS</b></p> <table border="1"> <thead> <tr> <th>NO.</th> <th>DATE</th> <th>DESCRIPTION</th> </tr> </thead> <tbody> <tr> <td>1</td> <td>10/1/14</td> <td>ISSUED FOR PERMITS</td> </tr> <tr> <td>2</td> <td>10/1/14</td> <td>ISSUED FOR PERMITS</td> </tr> <tr> <td>3</td> <td>10/1/14</td> <td>ISSUED FOR PERMITS</td> </tr> <tr> <td>4</td> <td>10/1/14</td> <td>ISSUED FOR PERMITS</td> </tr> <tr> <td>5</td> <td>10/1/14</td> <td>ISSUED FOR PERMITS</td> </tr> <tr> <td>6</td> <td>10/1/14</td> <td>ISSUED FOR PERMITS</td> </tr> <tr> <td>7</td> <td>10/1/14</td> <td>ISSUED FOR PERMITS</td> </tr> <tr> <td>8</td> <td>10/1/14</td> <td>ISSUED FOR PERMITS</td> </tr> <tr> <td>9</td> <td>10/1/14</td> <td>ISSUED FOR PERMITS</td> </tr> <tr> <td>10</td> <td>10/1/14</td> <td>ISSUED FOR PERMITS</td> </tr> </tbody> </table>	NO.	DATE	DESCRIPTION	1	10/1/14	ISSUED FOR PERMITS	2	10/1/14	ISSUED FOR PERMITS	3	10/1/14	ISSUED FOR PERMITS	4	10/1/14	ISSUED FOR PERMITS	5	10/1/14	ISSUED FOR PERMITS	6	10/1/14	ISSUED FOR PERMITS	7	10/1/14	ISSUED FOR PERMITS	8	10/1/14	ISSUED FOR PERMITS	9	10/1/14	ISSUED FOR PERMITS	10	10/1/14	ISSUED FOR PERMITS	<p><b>SCALE:</b></p> <p>PLAN: 1" = 40'</p> <p>CROSS SECTION: 1" = 4'</p>	<p><b>WYKANE COUNTY ENGINEERING</b></p> <p>1000 W. 10TH ST. SPOKANE, WA 99201</p> <p>PHONE: (509) 325-4400</p> <p>FAX: (509) 325-4401</p> <p>WWW.WYKANEENGINEERING.COM</p>	<p><b>PROJECT AND DRAWING NAME</b></p> <p><b>TAKODA PARK 2ND ADDITION</b></p> <p>BRONIA ROAD TEL. 2+00 TO TEL. 2+00.75</p> <p>WYKANE COUNTY, WASHINGTON</p>	<p><b>DATE:</b> 10/1/14</p> <p><b>OF 18</b></p> <p><b>ISSUED FOR PERMITS</b></p>
NO.	DATE	DESCRIPTION																																			
1	10/1/14	ISSUED FOR PERMITS																																			
2	10/1/14	ISSUED FOR PERMITS																																			
3	10/1/14	ISSUED FOR PERMITS																																			
4	10/1/14	ISSUED FOR PERMITS																																			
5	10/1/14	ISSUED FOR PERMITS																																			
6	10/1/14	ISSUED FOR PERMITS																																			
7	10/1/14	ISSUED FOR PERMITS																																			
8	10/1/14	ISSUED FOR PERMITS																																			
9	10/1/14	ISSUED FOR PERMITS																																			
10	10/1/14	ISSUED FOR PERMITS																																			

**CONSTRUCTION NOTES**

1. CONTRACT SHALL BE BASED ON SETS 2, 3, 4 & 5.
2. ALL WORK SHALL BE ACCORDING TO THE STANDARD SPECIFICATIONS FOR PUBLIC WORKS, WASHINGTON, 1997 EDITION, LATEST REVISIONS, UNLESS OTHERWISE SPECIFIED.
3. THE CONTRACTOR SHALL BE RESPONSIBLE FOR OBTAINING ALL NECESSARY PERMITS FROM THE APPLICABLE AGENCIES.
4. THE CONTRACTOR SHALL BE RESPONSIBLE FOR OBTAINING ALL NECESSARY PERMITS FROM THE APPLICABLE AGENCIES.
5. THE CONTRACTOR SHALL BE RESPONSIBLE FOR OBTAINING ALL NECESSARY PERMITS FROM THE APPLICABLE AGENCIES.
6. THE CONTRACTOR SHALL BE RESPONSIBLE FOR OBTAINING ALL NECESSARY PERMITS FROM THE APPLICABLE AGENCIES.
7. THE CONTRACTOR SHALL BE RESPONSIBLE FOR OBTAINING ALL NECESSARY PERMITS FROM THE APPLICABLE AGENCIES.
8. THE CONTRACTOR SHALL BE RESPONSIBLE FOR OBTAINING ALL NECESSARY PERMITS FROM THE APPLICABLE AGENCIES.
9. THE CONTRACTOR SHALL BE RESPONSIBLE FOR OBTAINING ALL NECESSARY PERMITS FROM THE APPLICABLE AGENCIES.
10. THE CONTRACTOR SHALL BE RESPONSIBLE FOR OBTAINING ALL NECESSARY PERMITS FROM THE APPLICABLE AGENCIES.

DATE	DESCRIPTION
10/1/00	ISSUED
10/1/00	ISSUED
10/1/00	ISSUED
10/1/00	ISSUED
10/1/00	ISSUED

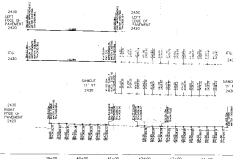
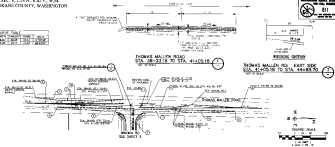

**STREET AND DRAINAGE PLANS**  
TANODA PARK PHASE II  
SPOKANE COUNTY, WASHINGTON



SCALE: HORIZONTAL: AS SHOWN VERTICAL: AS SHOWN

DATE: 10/1/00	SCALE: HORIZONTAL: AS SHOWN
PROJECT: TANODA PARK PHASE II	SCALE: VERTICAL: AS SHOWN
CONTRACT NO.: 2008-438	DATE: 10/1/00



**STREET AND DRAINAGE PLANS**  
**TANODA PARK PHASE II**  
THOMAS MALLIN RD STA. 38+22.18 TO STA. 41+02.18  
SPOKANE COUNTY, WASHINGTON

SHEET  
A OF 10  
PROJECT NO.  
2008-438



INTERSECTION DETAIL  
NADIA RD



INTERSECTION DETAIL  
NADIA RD



1. 1/2012  
2. 1/2012  
3. 1/2012

NO.	DATE	DESCRIPTION
1	1/2012	PRELIMINARY
2	1/2012	REVISED
3	1/2012	REVISED

SCALE  
AS SHOWN  
TYPICAL  
SEE

PROJECT NO. 10000  
DATE 01/15/2012  
SHEET NO. 8 OF 12  
PROJECT NAME  
SPOKANE COUNTY, WASHINGTON



STREET AND DRAINAGE PLANS  
TAKODA PARK PHASE II  
INTERSECTION DETAILS  
SPOKANE COUNTY, WASHINGTON

SHEET  
8 OF 12  
DATE  
2008-09-08

0.17250 Eng - 1/2012  
1/2012

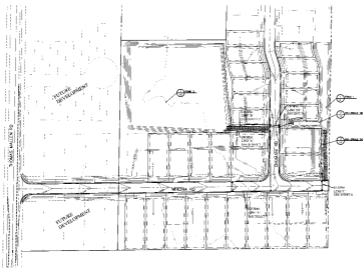

**BOARDING QUANTITIES**  
 TABLE 101  
 BOARDING QUANTITIES  
 (SEE GENERAL NOTES AND SPECIFICATIONS)



1. SEE PLAN FOR ALL DIMENSIONS AND NOTES.  
 2. SEE SPECIFICATIONS FOR ALL MATERIALS AND CONSTRUCTION METHODS.

NO.	DESCRIPTION	DATE
1	ISSUED FOR PERMIT	10/10/10
2	ISSUED FOR CONSTRUCTION	10/10/10
3	ISSUED FOR AS-BUILT	10/10/10

SCALE	PROJECT	DATE
AS SHOWN	TAKODA PARK PHASE II	10/10/10
AS SHOWN	STREET AND DRAINAGE PLAN	10/10/10



**STREET AND DRAINAGE PLAN**  
**TAKODA PARK PHASE II**  
 OVERALL BOARDING PLAN  
 SPOKANE COUNTY, WASHINGTON

SHEET  
 8 OF 18  
 JOB NUMBER  
 2008-408



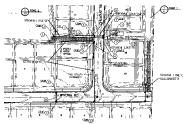

**CONSTRUCTION NOTES**

1. SEE ALL NOTES ON SHEETS 200-426, 200-427, 200-428, 200-429, 200-430, 200-431, 200-432, 200-433, 200-434, 200-435, 200-436, 200-437, 200-438, 200-439, 200-440, 200-441, 200-442, 200-443, 200-444, 200-445, 200-446, 200-447, 200-448, 200-449, 200-450, 200-451, 200-452, 200-453, 200-454, 200-455, 200-456, 200-457, 200-458, 200-459, 200-460, 200-461, 200-462, 200-463, 200-464, 200-465, 200-466, 200-467, 200-468, 200-469, 200-470, 200-471, 200-472, 200-473, 200-474, 200-475, 200-476, 200-477, 200-478, 200-479, 200-480, 200-481, 200-482, 200-483, 200-484, 200-485, 200-486, 200-487, 200-488, 200-489, 200-490, 200-491, 200-492, 200-493, 200-494, 200-495, 200-496, 200-497, 200-498, 200-499, 200-500.
2. EXISTING MANHOLE TO REMAIN 1.000' x 1.000'.
3. NEW MANHOLE SHALL BE 1.000' x 1.000'.
4. EXISTING STORM DRAIN SHALL REMAIN.
5. EXISTING STORM DRAIN SHALL BE 12\"/>

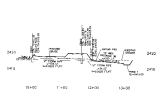
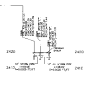
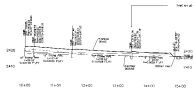

Project No. 200-426  
 Date: 12/15/2018  
 Scale: AS SHOWN

NO.	DESCRIPTION	DATE	BY	CHECKED BY
1	DESIGN	12/15/2018	JW	AW
2	CHECK	12/15/2018	AW	AW
3	REVISION			



**STREET AND DRAINAGE PLANS  
 TAKODA PARK PHASE II  
 STORM LINES A AND B  
 SPOKANE COUNTY, WASHINGTON**

SHEET  
 7 OF 18  
 12/15/2018  
 200-426



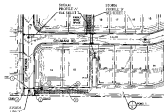

**CONSTRUCTION NOTES**

1. SEE ALL NOTES ON SHEET 8-12 FOR ALL NOTES CONCERNING THE SEWER MAIN AND MANHOLES.
2. SEE SHEET 8-13 FOR ALL NOTES CONCERNING THE SEWER MAIN AND MANHOLES.
3. SEE SHEET 8-14 FOR ALL NOTES CONCERNING THE SEWER MAIN AND MANHOLES.
4. SEE SHEET 8-15 FOR ALL NOTES CONCERNING THE SEWER MAIN AND MANHOLES.
5. SEE SHEET 8-16 FOR ALL NOTES CONCERNING THE SEWER MAIN AND MANHOLES.



8-1758

NO.	DATE	BY	DESCRIPTION

SCALE	DATE	BY	DESCRIPTION



**STREET AND DRAINAGE PLANS  
TAKODA PARK PHASE II  
SEWER LINE 12  
SPOKANE COUNTY, WASHINGTON**

**SHEET  
8 OF 12  
JOB NUMBER  
8208-428**

8-1758 8/24/18  
JRW

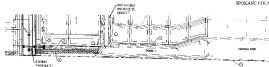

**CONSTRUCTION NOTES**

1. SEE PLAN
2. EXISTING GRADE SHALL BE MAINTAINED UNLESS OTHERWISE NOTED
3. EXISTING GRADE SHALL BE MAINTAINED UNLESS OTHERWISE NOTED
4. EXISTING GRADE SHALL BE MAINTAINED UNLESS OTHERWISE NOTED
5. EXISTING GRADE SHALL BE MAINTAINED UNLESS OTHERWISE NOTED
6. EXISTING GRADE SHALL BE MAINTAINED UNLESS OTHERWISE NOTED

**NOTE**

CONSTRUCTION SHALL BE IN ACCORDANCE WITH THE STANDARD SPECIFICATIONS FOR PUBLIC WORKS OF THE STATE OF WASHINGTON.

**CONSTRUCTION SCHEDULE**

NO.	DESCRIPTION	START DATE	END DATE
1	CONSTRUCTION	08/01/2010	08/31/2010
2	CONSTRUCTION	09/01/2010	09/30/2010
3	CONSTRUCTION	10/01/2010	10/31/2010
4	CONSTRUCTION	11/01/2010	11/30/2010
5	CONSTRUCTION	12/01/2010	12/31/2010

**CONSTRUCTION SCHEDULE**

NO.	DESCRIPTION	START DATE	END DATE
1	CONSTRUCTION	08/01/2010	08/31/2010
2	CONSTRUCTION	09/01/2010	09/30/2010
3	CONSTRUCTION	10/01/2010	10/31/2010
4	CONSTRUCTION	11/01/2010	11/30/2010
5	CONSTRUCTION	12/01/2010	12/31/2010

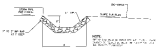

DATE: 08/01/2010  
DRAWN BY: J. SMITH

NO.	DESCRIPTION	DATE
1	CONSTRUCTION	08/01/2010
2	CONSTRUCTION	09/01/2010
3	CONSTRUCTION	10/01/2010
4	CONSTRUCTION	11/01/2010
5	CONSTRUCTION	12/01/2010

**SCALE**

NO.	DESCRIPTION	DATE
1	CONSTRUCTION	08/01/2010
2	CONSTRUCTION	09/01/2010
3	CONSTRUCTION	10/01/2010
4	CONSTRUCTION	11/01/2010
5	CONSTRUCTION	12/01/2010



**STREET AND DRAINAGE PLAN**  
**TAKODA PARK PHASE II**  
SPOKANE COUNTY, WASHINGTON

SHEET  
3 OF 12  
JOB NO. 1000  
3000-428

*p. 1000 08/01/2010*



ALL ALL GRADES SHALL BE BUILT WITH A MINIMUM 2% SLOPE AWAY FROM DRAINAGE STRUCTURE.  
 1. 5' BERM  
 2. 1' SLOPE ON INSIDE AND OUTSIDE  
 3. 1' SLOPE ON POND FLOOR  
 4. 1' BELOW 5' BERM LEVEL

CONSTRUCTION NOTES:  
 1. ALL GRADES SHALL BE BUILT WITH A MINIMUM 2% SLOPE AWAY FROM DRAINAGE STRUCTURE.  
 2. 5' BERM  
 3. 1' SLOPE ON INSIDE AND OUTSIDE  
 4. 1' SLOPE ON POND FLOOR  
 5. 1' BELOW 5' BERM LEVEL

TYPICAL POND WITHOUT DRAINAGE STRUCTURE  
 SEE FIG. 1

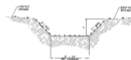

ALL ALL GRADES SHALL BE BUILT WITH A MINIMUM 2% SLOPE AWAY FROM THE FOLLOWING DRAINAGE STRUCTURE:  
 1. 5' BERM  
 2. 1' SLOPE ON INSIDE AND OUTSIDE  
 3. 1' SLOPE ON POND FLOOR  
 4. 1' BELOW 5' BERM LEVEL

TYPICAL 60-INCH WIDE SECTION  
 SEE FIG. 2

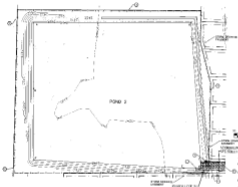

- CONSTRUCTION NOTES:  
 1. ALL GRADES SHALL BE BUILT WITH A MINIMUM 2% SLOPE AWAY FROM DRAINAGE STRUCTURE.  
 2. 5' BERM  
 3. 1' SLOPE ON INSIDE AND OUTSIDE  
 4. 1' SLOPE ON POND FLOOR  
 5. 1' BELOW 5' BERM LEVEL

**POND 2 BOTTOM LOCATION TABLE**

STATION	ELEVATION
1+00	100.00
2+00	100.00
3+00	100.00
4+00	100.00
5+00	100.00
6+00	100.00
7+00	100.00
8+00	100.00
9+00	100.00
10+00	100.00

**POND 2 BOTTOM**

STATION	ELEVATION
1+00	100.00
2+00	100.00
3+00	100.00
4+00	100.00
5+00	100.00
6+00	100.00
7+00	100.00
8+00	100.00
9+00	100.00
10+00	100.00

**NOTE:**  
 1. ALL GRADES SHALL BE BUILT WITH A MINIMUM 2% SLOPE AWAY FROM DRAINAGE STRUCTURE.  
 2. 5' BERM  
 3. 1' SLOPE ON INSIDE AND OUTSIDE  
 4. 1' SLOPE ON POND FLOOR  
 5. 1' BELOW 5' BERM LEVEL

POND 2  
 SCALE: 1"=20'







**GRAVEL AND WIRE MESH  
 IN PLACE**  
 1/2" TO 1/4"



**GRAVEL OUTLET PROTECTION**  
 1/2" TO 1/4"



**CROSS SECTION**

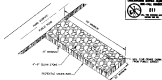

**CONSTRUCTION ENTRANCE**  
 1/2" TO 1/4"

SEE THE GRASS STRIP AND BUFFER STRIP FOR THE SET OF PLANS AND EXPLANATION  
 CONCERNING THE GRASS STRIP AND BUFFER STRIP FOR THE SET OF PLANS.

**CONSTRUCTION ENTRANCE**  
 1/2" TO 1/4"

SEE THE GRASS STRIP AND BUFFER STRIP FOR THE SET OF PLANS AND EXPLANATION CONCERNING THE GRASS STRIP AND BUFFER STRIP FOR THE SET OF PLANS.



**SHEET PILE INSTALLATION**  
 1/2" TO 1/4"

**SEGMENTATION/TIE ROD WITHOUT WIRE SUPPORT**  
 1/2" TO 1/4"

SEE THE GRASS STRIP AND BUFFER STRIP FOR THE SET OF PLANS AND EXPLANATION CONCERNING THE GRASS STRIP AND BUFFER STRIP FOR THE SET OF PLANS AND EXPLANATION CONCERNING THE GRASS STRIP AND BUFFER STRIP FOR THE SET OF PLANS.

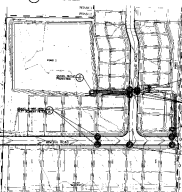
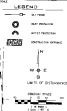

**SEE PLAN**  
 1/2" TO 1/4"

SCALE  
 1" = 10'

SCALE  
 1" = 10'

SCALE  
 1" = 10'



**STREET AND DRIVEWAY PLANS  
 TAKODA PARK PHASE II  
 WOODROW COUNTY, ILLINOIS**



**SHEET**  
 1E OF 18  
 10/18/2018  
 1008-430

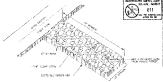
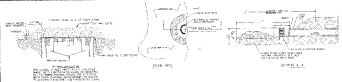

GRADE AND WIRE MARK  
 SHALL REMAIN IN PLACE  
 THROUGHOUT PROJECT

**LEGEND**

- ① CHAIN LINK FENCE
  - ② VINYL FENCE
  - ③ WOOD FENCE
  - ④ POST AND RAIL FENCE
  - ⑤ SLAT FENCE
- NORTH  
  
 SCALE: 1" = 40'

**GENERAL NOTES**

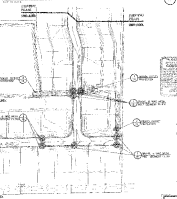

**CONSTRUCTION DETAILS**

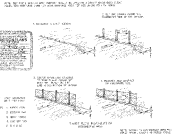

**CONSTRUCTION DETAIL FENCE WITHOUT WIRE DETAIL**

ALL FENCE SHALL BE INSTALLED WITH 1/2" DIA. GALV. STEEL POSTS AND RAILS. ALL FENCE SHALL BE INSTALLED WITH 1/2" DIA. GALV. STEEL POSTS AND RAILS. ALL FENCE SHALL BE INSTALLED WITH 1/2" DIA. GALV. STEEL POSTS AND RAILS.

**SITE PLAN**  
 12/25/2015

**PROJECT:** TAKOMA PARK 3RD ADDITION  
**CLIENT:** WASHINGTON COUNTY  
**DATE:** 12/25/2015

NO.	DESCRIPTION	DATE
1	ISSUED FOR PERMIT	12/25/2015
2	ISSUED FOR CONSTRUCTION	12/25/2015
3	ISSUED FOR AS-BUILT	12/25/2015

**SCALE:** 1" = 40'  
**DATE:** 12/25/2015  
**BY:** [Signature]



**STREET AND DRIVEWAY PLAN**  
**TAKOMA PARK 3RD ADDITION**  
 WASHINGTON COUNTY, MARYLAND



**SHEET:** 16 OF 16  
**DATE:** 12/25/2015