

FREYA MEADOWS SHORT PLAT

SW QTR. S.3, T.24 N., R.43 E., W.M.

CALL BEFORE YOU DIG
1-800-424-5555
ONE CALL NUMBER
48 HR. NOTICE REQUIRED

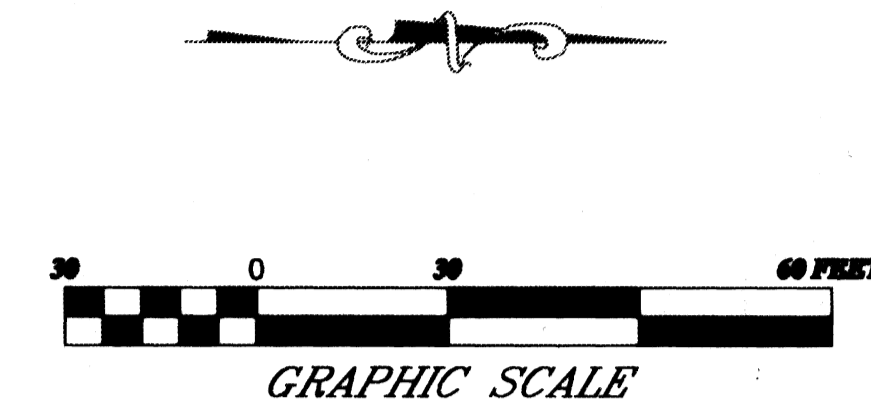
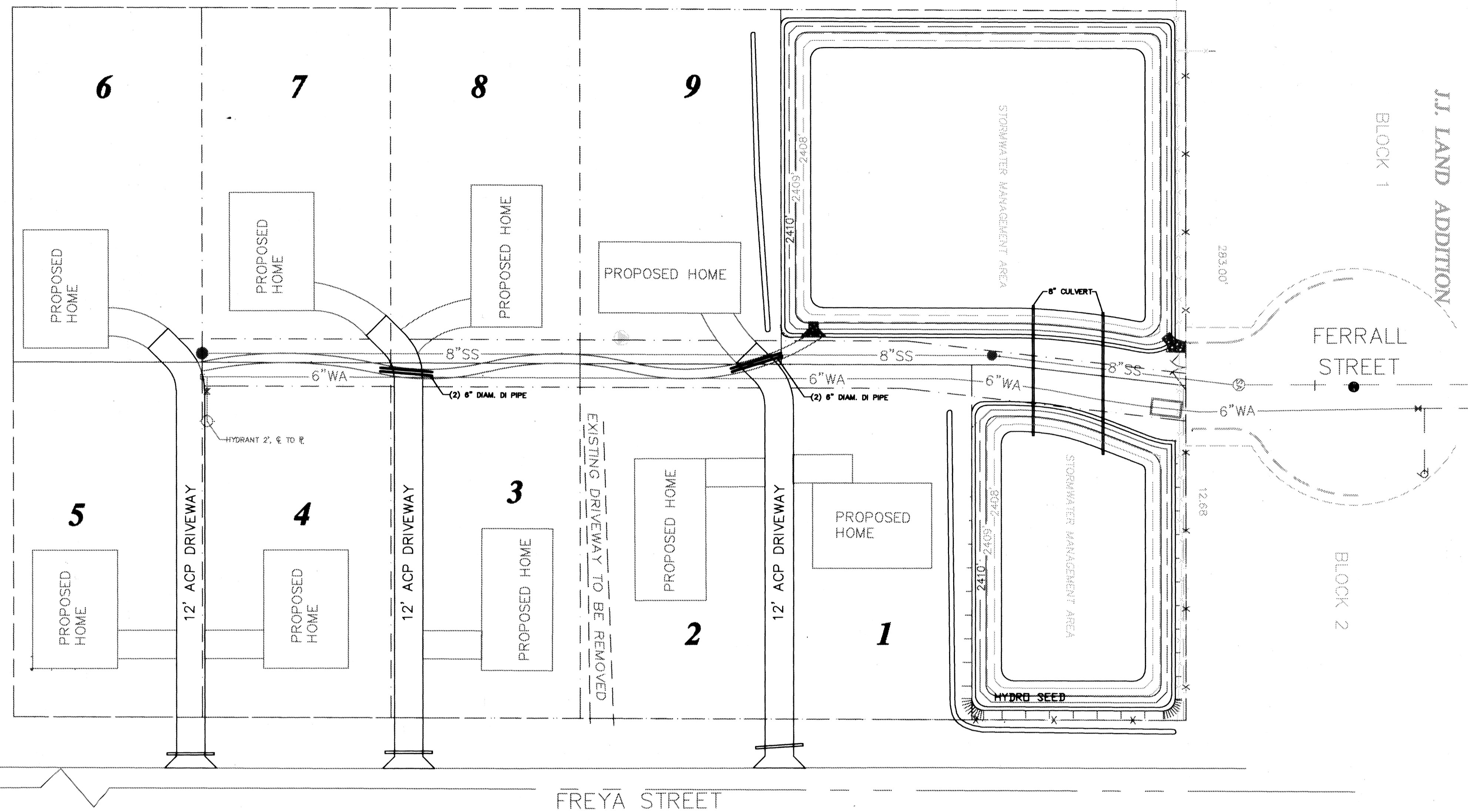

RETENTION POND A CRITERIA
RETENTION VOLUME= 37,476 CUBIC FT.
OVERFLOW VOLUME= 57,252 CUBIC FT.
BOTTOM ELEV.= 2,406.98', AREA= 15,543.03'
RETENTION ELEV.= 2,409.15', AREA= 18,997.19'
ELEV. AT OVERFLOW= 2,410.15', AREA= 20,577.81'

RETENTION POND B CRITERIA
RETENTION VOLUME= 15,609 CUBIC FT.
OVERFLOW VOLUME= 24,419 CUBIC FT.
BOTTOM ELEV.= 2,406.98', AREA= 6,073.04'
RETENTION ELEV.= 2,409.15', AREA= 8,312.89'
ELEV. AT OVERFLOW= 2,410.15', AREA= 9,333.31'

COMBINED RETENTION POND CRITERIA
RETENTION VOLUME= 53,085 CUBIC FT.
TOTAL VOLUME= 81,671 CUBIC FT.
BOTTOM ELEV.= 2,406.98', AREA= 21,616.07'
RETENTION ELEV.= 2,409.15', AREA= 27,310.08'
ELEV. AT OVERFLOW= 2,410.15', AREA= 29,911.11'

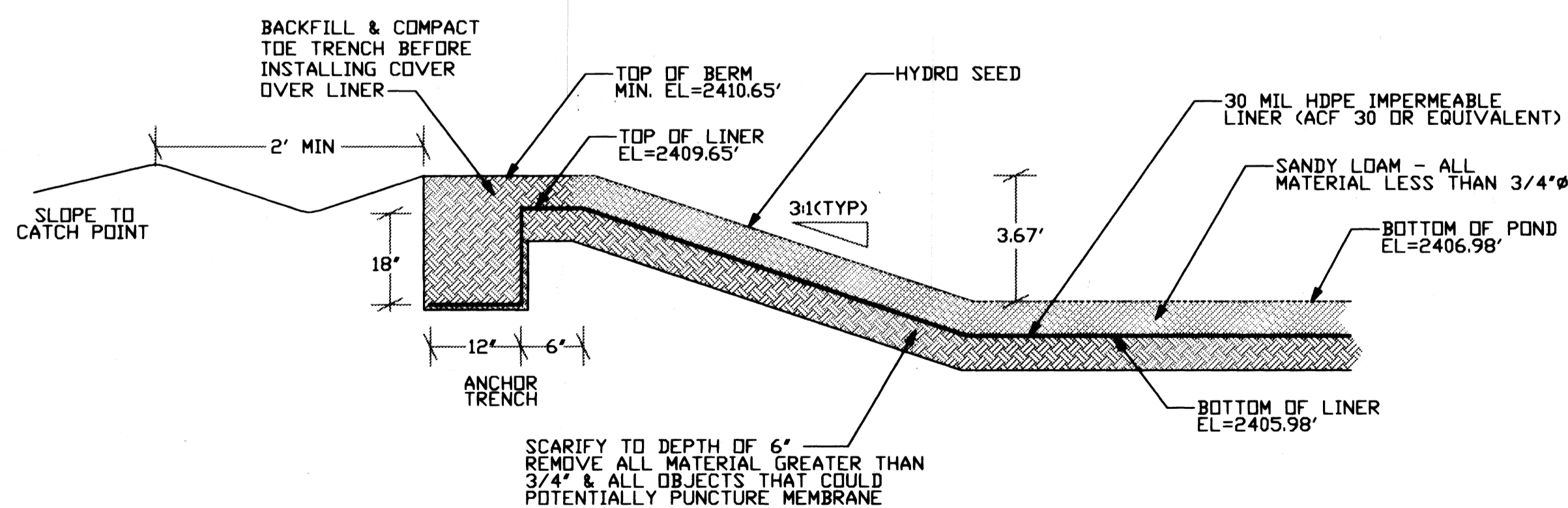

1
1 NTS
DETAIL - POND CROSS SECTION W/
MEMBRANE ANCHOR TRENCH

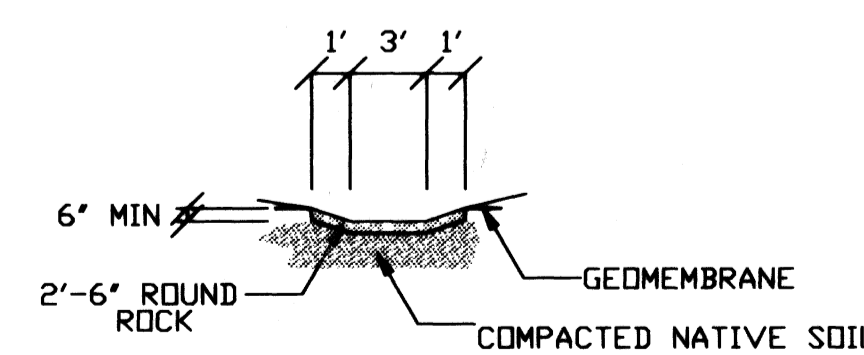

2
1 NTS
DETAIL - CHANNEL CROSS SECTION

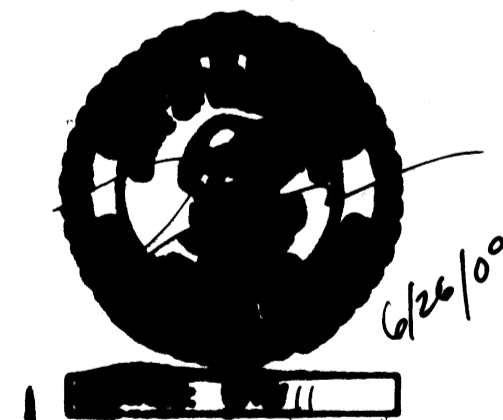
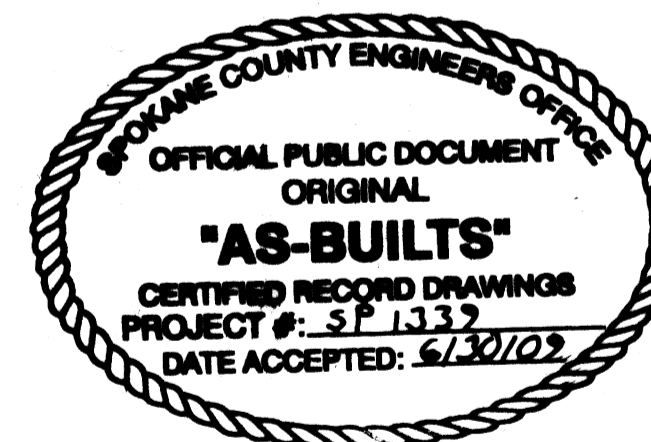

ENGINEER'S CERTIFICATION
I HAVE REVIEWED THE CONSTRUCTION AND TO MY KNOWLEDGE FIND IT TO BE IN SUBSTANTIAL CONFORMANCE WITH THE APPROVED CERTIFIED PLANS AND STANDARD SPECIFICATIONS EXCEPT WHERE NOTED.

MICHAEL NILSSON, PE
CIVIL ENGINEER

The Engineer's Seal was removed during the As-Built process. The information of record is as follows:			
Proj. No.	Engineer's Name	Eng.'s No.	Date on Plan
SP1339-00	MICHAEL K NILSSON	40871	12/09/05

RECORD DRAWING

DATE & REVISION

Nilsson Engineering, PLLC
P. O. Box 28 • Cobalt, WA 99005
Phone (509) 828-1864 • Fax (509) 467-2142
nilssoneng@comcast.net

DESIGNED: MKN
DRAWN: MKN
CHECKED: MKN
DATE: 06-18-2009
JOB#: FREYA/1

AB&K CONSTRUCTION
KENTON COX

STORM PLAN
FREYA MEADOWS

FIG
1