

Assessor's Section Status

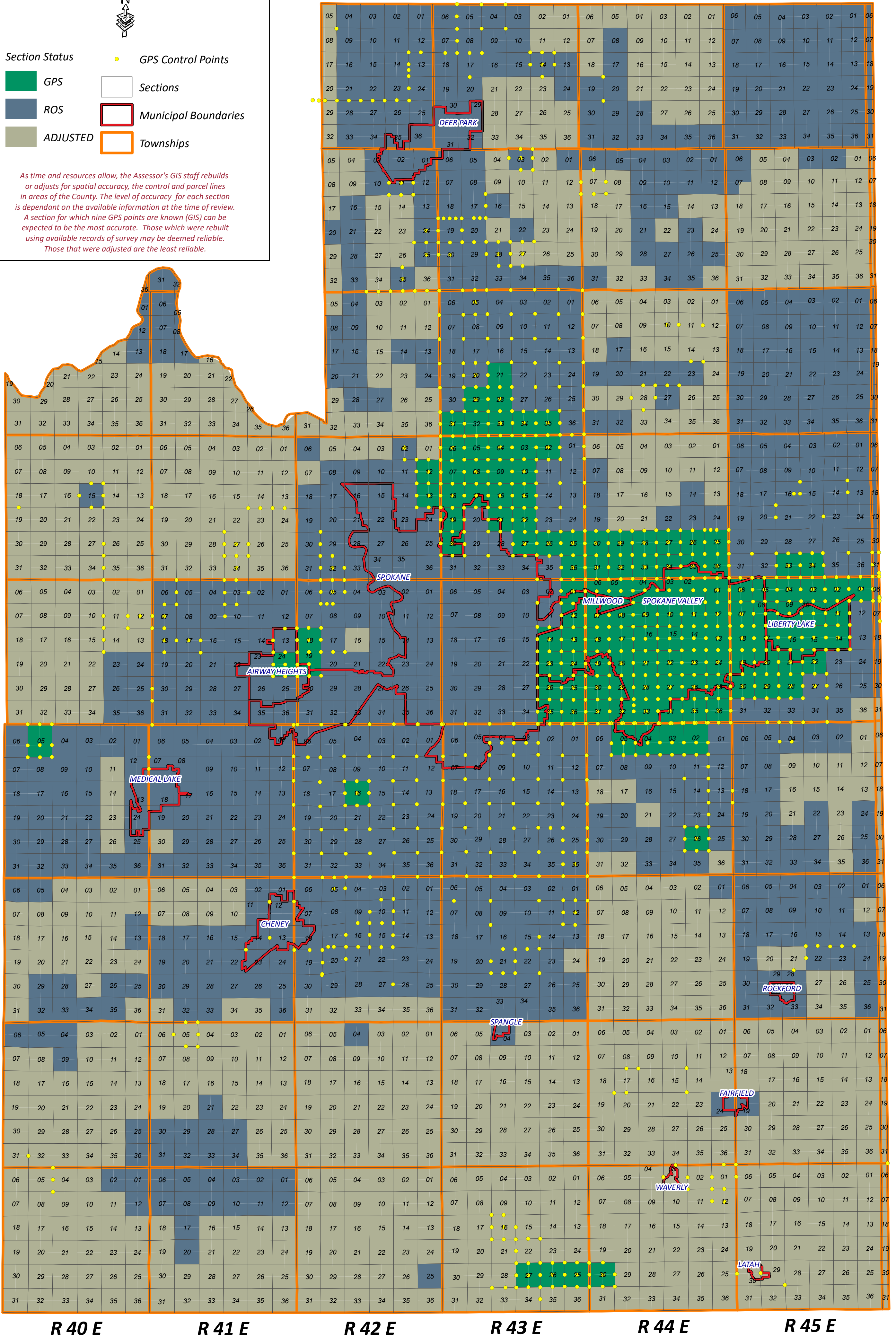

- Section Status**
- GPS
 - ROS
 - ADJUSTED
 - GPS Control Points
 - Sections
 - Municipal Boundaries
 - Townships

As time and resources allow, the Assessor's GIS staff rebuilds or adjusts for spatial accuracy, the control and parcel lines in areas of the County. The level of accuracy for each section is dependant on the available information at the time of review. A section for which nine GPS points are known (GIS) can be expected to be the most accurate. Those which were rebuilt using available records of survey may be deemed reliable. Those that were adjusted are the least reliable.



T 29 N

T 28 N

T 27 N

T 26 N

T 25 N

T 24 N

T 23 N

T 22 N

T 21 N

R 40 E

R 41 E

R 42 E

R 43 E

R 44 E

R 45 E